

-40°C Ultra-low Temperature Freezer

2019 Brand New Product

Targeted Refrigeration • Fast Refrigeration

Energy-saving & Environmentally Friendly



LT40-531U

Refrigeration System

- Freon-free refrigerant, compressor supplied by an international famous brand and EBM fan can guarantee fast cooling and are energy-saving and environmentally friendly;
- Refrigerating circuit with proprietary intellectual property rights ensures high efficiency and stability;
- Two-layer heat insulating foamed door and the insulation design of the outer door system with multiple patents can prevent loss of refrigerating capacity in an effective way;
- Six sides of the cabinet are made from high-performance vacuum insulation material, improving thermal insulation performance to a large extent.

Temperature Control System

High-precision microcomputer temperature control system and platinum resistor temperature sensors ensure more precise temperature control.

People-oriented Design

High-quality steel plate structure with phosphate coating, Galvanized steel liner and low noise design can create a comfortable environment.





High-precision Temperature Control

- The digital temperature display can show various parameters simultaneously, such as temperature inside the cabinet, power voltage and environmental temperature, indicating operating status clearly;
- The high-precision microcomputer temperature control system and platinum resistor temperature sensors enable users to set temperature inside the cabinet within a range from -20°C to -40°C.



Refrigeration System

- EBM fan are powerful, energy-saving and highly efficient;
- The large-area finned condenser is characterized by a space equal to or less than 2mm between fins, providing a large area for heat dissipation and satisfactory performance.

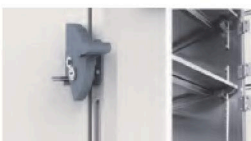

Human-oriented

- The rotating handle facilitates door opening;
- The adjustable layered structure is convenient for storage of various things;
- The liner made from High quality galvanized steel sheet for medical use is low-temperature tolerant and corrosion-resistant, which has a long service life and is easy to clean.



Thermal Insulation System

- The two-layer heat insulating foamed door with airbag-typed outer seal and the insulation design of the outer door system with multiple patents can prevent loss of refrigerating capacity in an effective way;



- High/low temperature alarm, power failure alarm, door ajar alarm, System failure, Main board communication error, High ambient temperature, Condenser cooling failure.
- Startup delay and stop interval protection function to ensure reliable operation;
- Keyboard lock and password protection function to prevent arbitrary adjustment of operating parameters;
- Safety door lock design, ensure sample storage is more secure.



Chart Recorder (optional)

- TEquipped with a printer;
- The filtering screen is removable and easy to clean.

✓ Scope of Application

Suitable for use in scientific research, cryogenic test on special materials, blood plasma cryopreservation, low temperature resistance test on biological materials, vaccines, biological products and military products, etc. Suitable for use in research institutions, the electronic industry, the chemical industry, hospitals, the health & disease prevention system, laboratories in colleges & universities, military enterprises, etc.

🔗 Performance Data / Cooling Curve

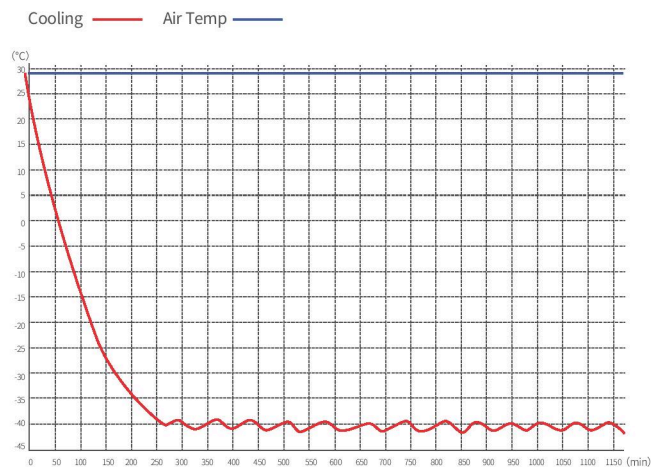

📐 External Dimension

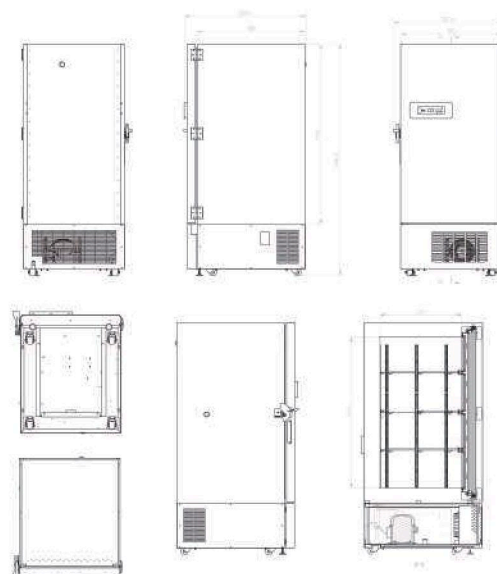

Specification Chart

-40°C Ultra-low Temperature Freezer	
Model	LT40-531U
Cabinet Type	Upright
Capacity(L)	531
Internal Size(W*D*H)mm	585*696*1266
External Size(W*D*H)mm	930*1041*1947
Package Size(W*D*H)mm	1025*1150*2085
NW/GW(Kgs)	234/272
Performance	
Temperature Range	-20 ~-40°C
Ambient Temperature	16-32°C
Cooling Performance	-40°C
Climate Class	N
Controller	Microprocessor
Display	Digital display
Refrigeration	
Compressor	1pc
Cooling Method	Direct cooling
Defrost Mode	Manual
Refrigerant	R507
Insulation Thickness(mm)	130
Construction	
External Material	High Quality Steel plates with spraying
Inner Material	Galvanized steel sheet
Shelves	3
Door Lock with Key	Yes
External Lock	Yes
Access Port	2pcs. Ø 25 mm
Casters	4(2 leveling feet)
Data Logging/Interval/Recording Time	USB/Record every 10 minute / 2 years
Backup Battery	Yes
Alarm	
Temperature	High/Low temperature,High ambient temperature
Electrical	Power failure,Low battery
System	Sensor error, Condenser cooling failure,Door ajar, System failure, Main board communication error,Built-in datalogger USB failure
Electrical	
Power Supply(V/HZ)	220/50
Rated Power(W)	470
Input Power(W)	580
Power Consumption(KWh/24h)	4.67
Rated Current(A)	2.66
Options Accessory	
System	RS485, RS232,Printer,Chart recorder,Remote alarm contact

*The model, parameters and performance specified in this brochure may be changed without prior notice because of product upgrading.

*There may be differences between the product images shown in this brochure and the actual products. When you are buying any product, please check the actual product.